

J. KENNETH SMITH BIRD SANCTUARY AND NATURE CENTER

J. KENNETH AND ALICE SMITH FAMILY FOUNDATION
412 NORTH KENTUCKY/P. O. BOX 2527
ROSWELL, NM 88201/CONTACT: STEVE SMITH
575-420-2100 CELL/575-622-7163 OFFICE

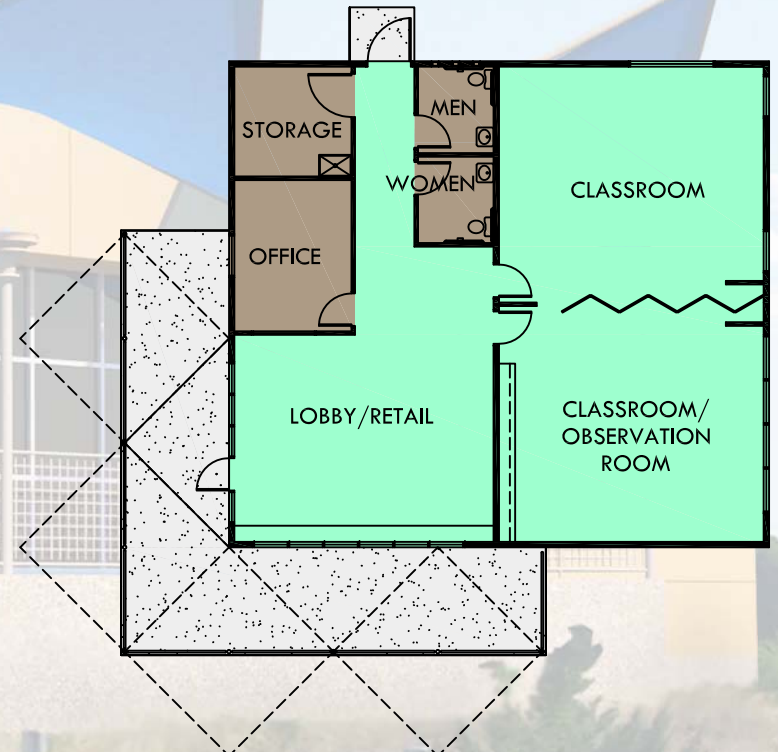

FLOOR PLAN

NPSR
ARCHITECTS, Inc.

606 West Pierce Street
Carlsbad, NM 88220
www.npsr.pro